

MERIDIAN



55" Outdoor Presenza

Installation Instructions

MERIDIAN

55" Outdoor Presenza Installation

After unpackaging the wrapping on the kiosk, place lifting chains or straps thru the two lifting eye bolts on the top of the kiosk.

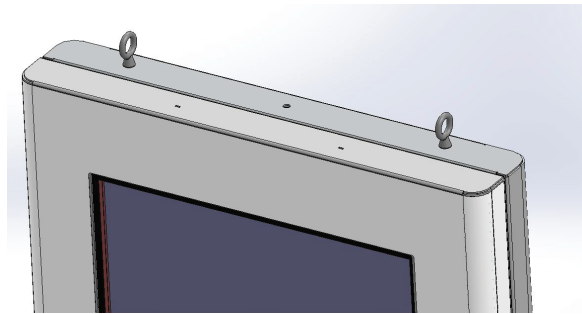

Ensure you have sufficiently supported the kiosk using the lift points provided prior to removing any fitting used to secure to pallet. This is critical as this unit is not a free standing design and requires mounting at all times.

Using the supplied key, place into the side lock and turn clockwise until it stops.

While keeping pressure to the right, pull out key and tumbler. With this removable key tumbler out, you can now install the t-handle supplied with the kiosk.

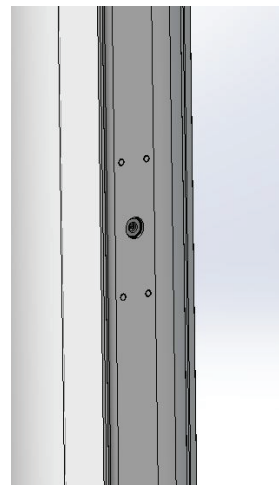
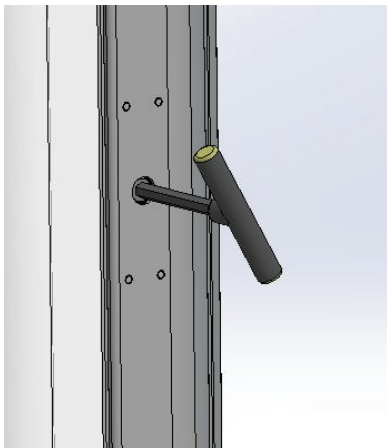

Insert the t-handle and turn counterclockwise to open the front door.

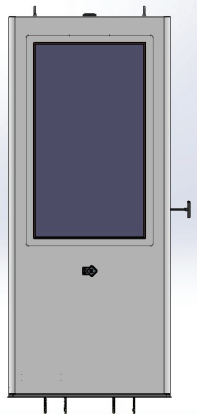
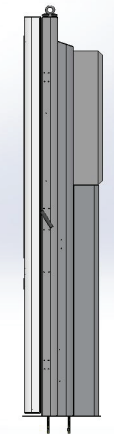
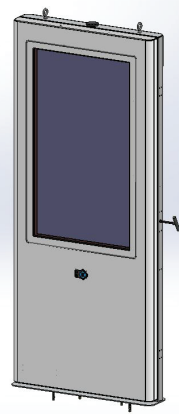
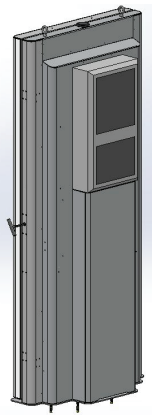

MERIDIAN

55" Outdoor Presenza Installation

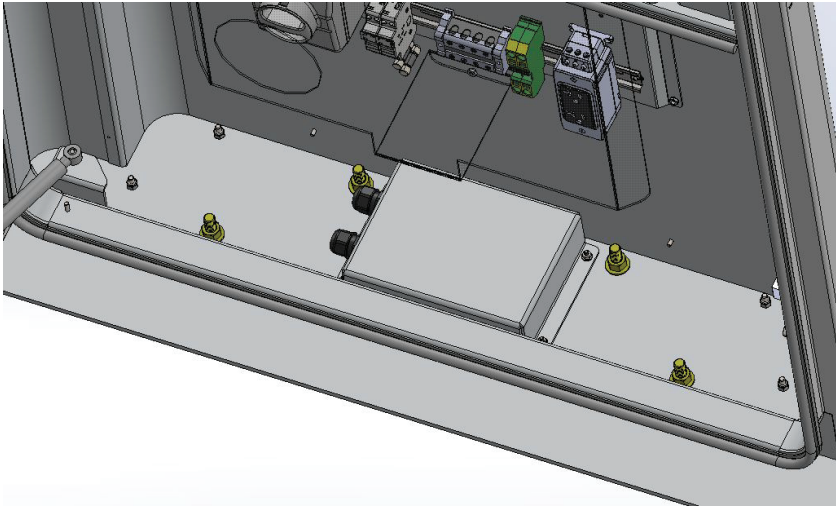

Once the front door is open, remove the four bolts holding this down to the pallet.

Once these are removed you can lift the kiosk and set into position over your existing concrete sleeve anchors (or your preferred hardware).

Once down in position, install the washers and nuts and tighten to your local code specs.

If slight leveling is needed, do this prior to tighten down the nuts.

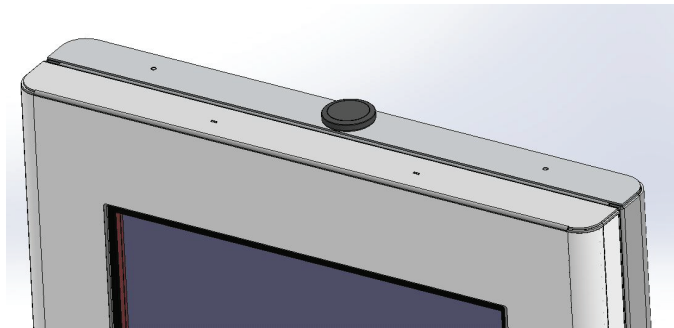

- Once the kiosk is fully tightened down, remove the lifting device along with the lifting eye bolts.
- Place the supplied antenna cap on the top with the studs facing downward into the kiosks.
- Place the antenna cabling and stud down thru the center holes in the topper.

- Install the supplied hardware and tighten down the two topper studs and secure the antenna nut.
- These will clamp the topper down to prevent water seeping into the opening for lifting.

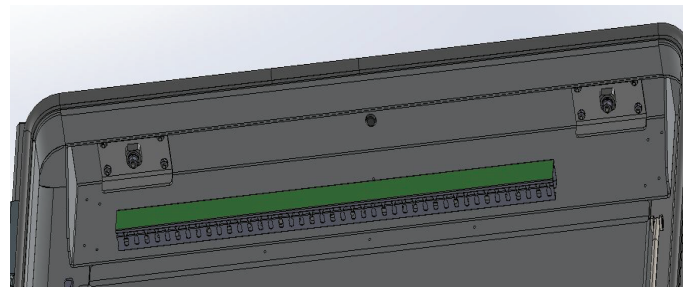

QUALITY + CERTIFICATION

Meridian promises a level of quality that goes beyond the expected. We control every step of our process from concept to completion, overseeing quality, design, cost and timelines. Many of our products can be UL Listed through UL self-certify and our processes are ISO 9001:2015 certified.



MERIDIAN

55" Outdoor Presenza Installation

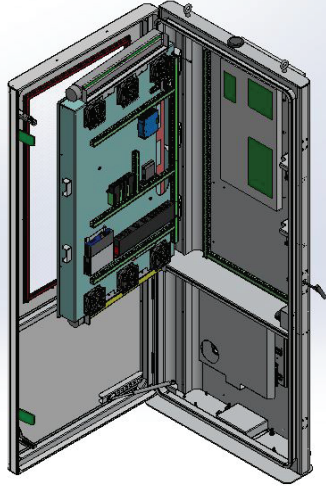

Route antenna wires down thru the cable ducting in the rear of the chassis and then across and up into the rear of the monitor pan and into cradle. Remove the lower power cover panel located in the bottom center of the chassis.

This cover can be removed via the single nut located at the lower edge of this panel.

Run incoming 120VAC 20-amp circuit up thru the bottom of the kiosk and thru the water-tight cord grip located on the left side.

Continue wire up back wall and into the disconnect located behind the electrical covering.

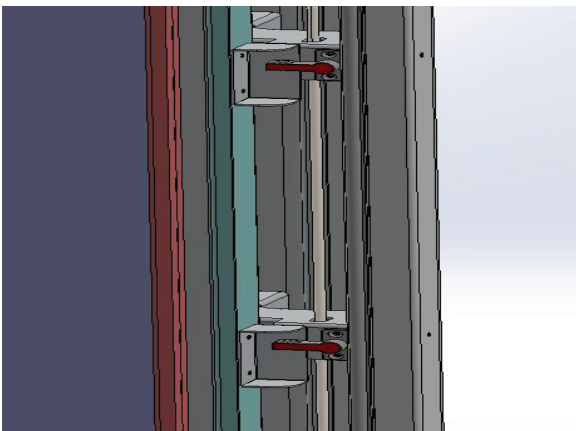

Locate the red handled clamps on the right side and turn counterclockwise to allow rear monitor pan to swing out.

Pull this outward until it stops to access all items and connection behind the monitor.

When closing this monitor housing, the lower right edge will contact a roller that will guide this into the correct location.

Once there, rotate the two red clamps clockwise, locking housing to the rear surface.

MERIDIAN

55" Outdoor Presenza Installation

Once all services are verified and working, close the monitor housing and lock into position. Then close the front door.

When closing the front door, make sure the t handle is turned the correct direction to allow the locking arms to pull inward.

This allow enough room for the door to close and the locking bars to clear the bar system.

Once the door is pushed against the rear chassis, turn the t handle to locking in the locking bars and rollers.

With the previously removed key and tumbler, insert and turn to the right (clockwise) again until it is fully seated and then turn counterclockwise.

Remove key from lock and your kiosk is now ready for using.

QUALITY + CERTIFICATION

Meridian promises a level of quality that goes beyond the expected. We control every step of our process from concept to completion, overseeing quality, design, cost and timelines. Many of our products can be UL Listed through UL self-certify and our processes are ISO 9001:2015 certified.



Corporate Headquarters

312 S. Pine Street,
Aberdeen, NC 28315

+1 866-454-6757
Sales@mzero.com

Meridiankiosks.com

